



2100105

**NOTICE SPECIFIQUE
SPECIFIC INSTRUCTIONS
ISTRUZIONI SPECIFICHE
MANUAL ESPECIFICO
GERÄTEANWEISUNG**

**POINT D'ANCRAGE
ANCHORAGE POINT
PUNTI DI ANCORAGGIO
PUNTOS DE ANCLAJE
ANSCHLAGPUNKTE**

CE EN795/B:1996

Résistance a la rupture Resistance to fracturing Resistenza alla rottura Resistenzigkeit Bruchfestigkeit	15KN
--	-------------

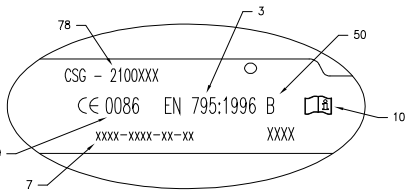
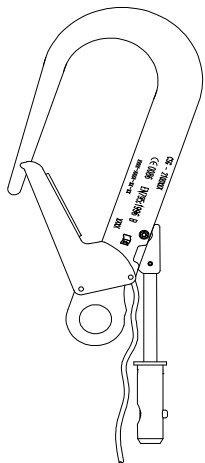

	0,6 kg	Mousqueton/composants snap hook/components gancho a scatto/componente gancho de cierre/componente karabinerhaken/komponente	Visserie Fasteners Bullone Tornilleria Bolzen 15	Cordelette String Cordino Cuercilla Schnur 12
Ouverture Opening Apertura Abertura Offnung 11	60mm	Matiere Material Materiale Material Material 18	Aluminium + Inox Aluminum + Stainless Inox Stainless steel	Polyamide Polyamid
Année de fabrication Manufacturing year Anno di fabbricazione Año de fabricación Baujahr 4	2018	EXAMEN CE DE TYPE CE TYPE EXAMEN ESAME CE DEL TIPO EFFETUATO EXAMEN CE DE TIPO EFETUADO POR CE-TYPENPRÜFUNG DURCH 8	N°0082 : APAVE SUDEUROPE SAS ZI Avenue Gay Lussac - BP 3 33370 ARTIGUES-près-BORDEAUX France	
BATCH / ID 7	12345678	SUMI QUALITE PRODUCTION QUALITY CONTROL ORGANISMO VALUTAZIONE CONFORMITA ORGANISMO DE CONTROLA HERSTELLUNGSKONTROLLE 9	N°0086 : BSI 389 Chiswick High Road LONDON W4 4AL UK	
3 660570 031179				

Veuillez lire la notice générale / Please read the general instructions / Leggere le istruzioni generali / Sivase leer el manual general / Bitte allgemeine anweisung lesen **49**

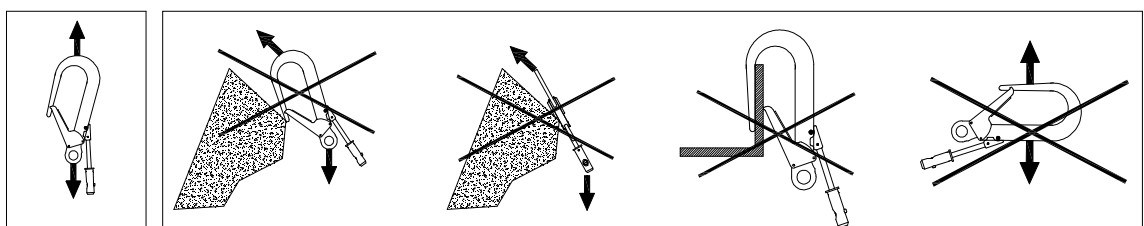
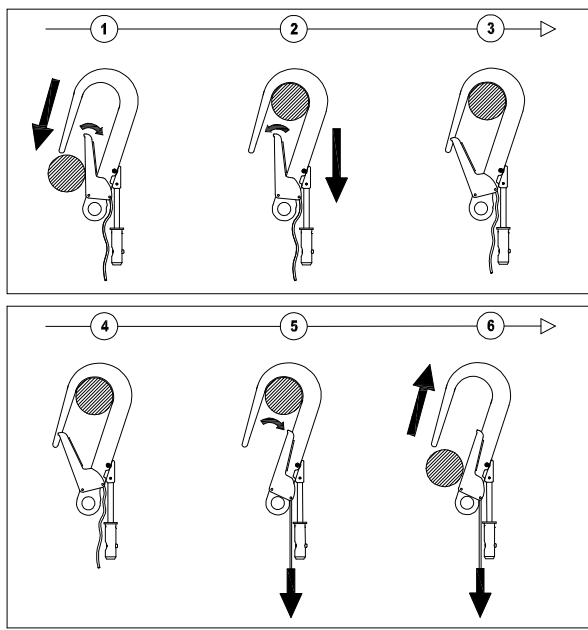
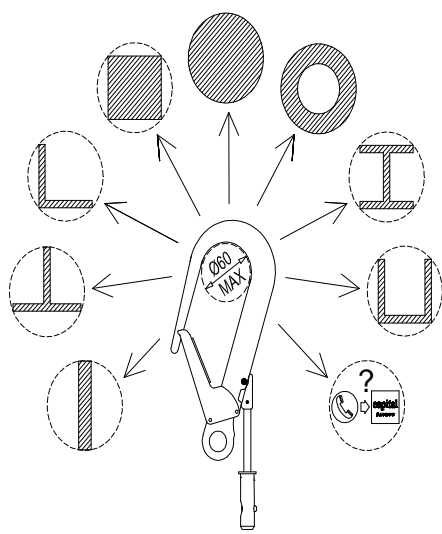

FR:
3 = Norme européenne
4 = Année de fabrication
5 = Mois de fabrication
6 = Numéro de série
7 = Numéro de lot
8 = Examen CE de type effectué par
9 = N° organisme controlant cet EPI
10 = Note: lire la notice
11 = Longueur
29 = Résistance à la rupture

EN:
3 = European Standard
4 = Year of manufacturing
5 = Month of manufacturing
6 = Serial number
7 = Batch number
8 = EC test performed by
9 = Number of Body checking the manufacturing
10 = Note: read the notice
11 = Length
29 = Breaking strength

IT:
3 = Norma europea
4 = Anno di fabbricazione
5 = Mese di fabbricazione
6 = Numero di serie
7 = Numero di lotto
8 = Esame CE del tipo effettuato da
9 = Numero dell'organismo di valutazione della conformità di questo EPI
10 = Note: leggere le istruzioni
11 = Lunghezza
29 = Resistenza alla rottura

ES:
3 = Normativa europea
4 = año de fabricación
5 = Mes de fabricación
6 = Número de serie
7 = Número de lote
8 = Examen CE de tipo efetuado por
9 = Número del organismo que controla la fabricación de este EPI
10 = Cuidado: leer el manual
11 = Longitud
29 = Resistencia a la rotura

DE:
3 = Europäische Norm
4 = Baujahr
5 = Herstellungsmonat
6 = Serien-Nummer
7 = Cargen-Nummer
8 = CE-Typenprüfung durch
9 = Nummer der mit der Herstellungs-kontrolle dieser
10 = Achtung: Anweisung lesen
11 = Länge
29 = Bruchfestigkeit